

Parts Breakdown for JVP-8 Vacuum Pump

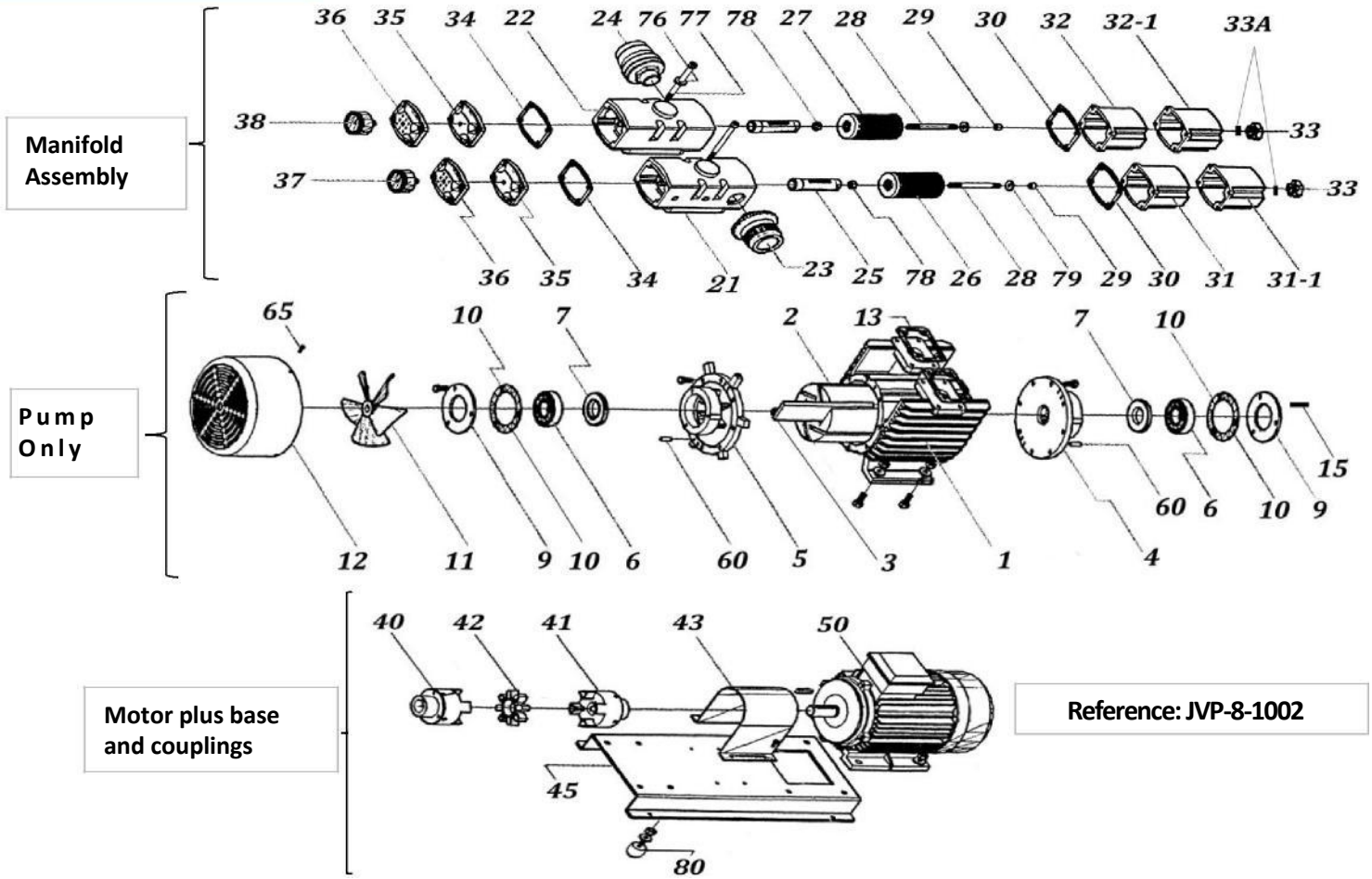

Reference: JVP-8-1002

#	Description	Qty	Catalog #
1	Cylinder	1	Call
2	Rotor	1	Call
3	*Vane	6	JVP-8-00003
4	Side Plate Motor Side	1	Call
5	Side Plate Fan Side	1	Call
6	*Bearing	2	JVP-7-00006
7	*Spacer	2	JVP-7-00007
9	Bearing Cover	2	JVP-7-00009
10	*Shim Paper	10	JVP-7-00010
11	Fan	1	JVP-7-00011P
12	Fan Cover	1	JVP-8-00012
13	*Manifold Gasket	1	JVP-8-00013
15	Key	1	JVP-8-00015
21	Manifold Case Only, Pressure	1	JVP-8-00021
	Manifold Complete Assembly- Pres.		Call
22	Manifold Case Only, Vacuum	1	JVP-8-00022
	Manifold Complete Assembly, Vacuum		Call
23	Pressure Regulator	1	JVP-1002-00023
24	Vacuum Regulator	1	JVP-1002-00024
25	Silencer Pipe Assembly	2	JVP-8-00025/28/78
26	Delivery Filter Element (Steel)	1	JVP-1002-00026
27	*Filter (Pleated Paper)	1	JVP-1002-00027
28	Filter Rod	2	JVP-8-00025/28/78
29	*Spring Tube	2	JVP-8-00029

#	Description	Qty	Catalog #
30	*Filter Gasket	2	JVP-8-00030
31	Muffler Cover (Metal)	1	JVP-8-00031
31-1	Muffler Cover w/ holes	1	JVP-8-00031-1
32	Filter Cover/Case (Clear)	1	JVP-8-00032
32-1	Filter Cover w/ holes (clear)	1	JVP-8-00032-1
33	Knob Nut	2	JVP-1002-00033
33a	*Gasket Washer for Filter Knob	1	JVP-1002-00033A
34	Manifold Cap Gasket	2	JVP-8-00034
35	Manifold Cap tapped for gauge V/P	2	JVP-8-00035
36	Manifold Cap w/holes	2	JVP-8-00036
37/38	Combination Vacuum/Pressure Gauge	1	JVP-ALL-0037/38
40/41	Pump and Motor Side Coupling	1	JVP-8-00040/41
42	*Spider Coupling	1	JVP-8-00042
43	Coupling Cover	1	JVP-8-00043
45	Base (Steel)	1	JVP-8-00045
50	Motor	1	Call
60	Pin, Spring		JVP-1002-00060
65	Round Head Screw	3	Call
76	*Washer, Copper	8	JVP-8-00076
77	Allen Bolt for Manifold	2	Call
78	Nut	2	JVP-8-00025/28/78
79	Filter Washer	4	Call
80	Rubber Feet	4	JVP-ALL-00080
	*Included In Rebuild Kit		